

2015-2019 CHEVY 2500-3500

FRONT BUMPER INSTALLATION INSTRUCTIONS



SAFETY

Know safety, no injury. Know injury, no safety. ~Author Unknown

- **READ ALL SAFETY INSTRUCTIONS BEFORE INSTALLATION**
 - FOLLOW ALL INSTRUCTIONS FOR PROPER ASSEMBLY
 - WEAR APPROPRIATE EYE PROTECTION
 - EXERCISE CARE WHEN LIFTING COMPONENTS
 - USE APPROPRIATE TORQUE FOR BOLTS
 - BLUE THREAD LOCKING COMPOUND IS RECOMMENDED ON ALL BOLTS
- SUGGESTED TORQUE VALUES FOR STEEL GRADE SAE 5 BOLTS

| BOLT DIAMETER (INCH) | TREADS PER INCH | TORQUE (POUND-FEET) |
|-------------------------|-----------------|------------------------|
| 1/4 | 20 | 7 |
| 5/16 | 18 | 14 |
| 3/8 | 16 | 25 |
| 7/16 | 14 | 40 |
| 1/2 | 13 | 60 |
| 9/16 | 12 | 88 |
| 5/8 | 11 | 120 |
| 3/4 | 10 | 200 |
| 7/8 | 9 | 302 |
| 1 | 8 | 466 |



2015-2019 Chevrolet 2500-3500 Front

I. PARTS LIST

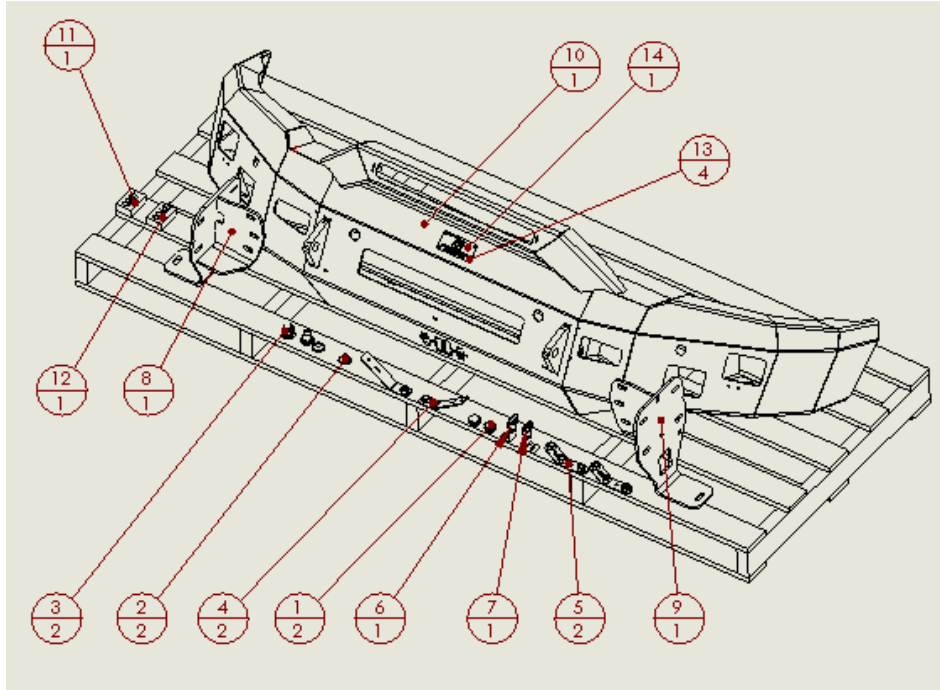

| ITEM NO. | QTY. | PART NUMBER | DESCRIPTION |
|----------|------|-------------|--------------------------------|
| 1 | 2 | 316-01-0005 | 1.25" PLUG BT-FLUSH LDPE BLACK |
| 2 | 2 | 601-56-2316 | OUTSIDE PLUG |
| 3 | 2 | 601-56-2401 | 2014 GM SENSOR SOLUTION |
| 4 | 2 | 601-56-2498 | WELDNUT TAB 1 |
| 5 | 2 | 601-56-2868 | WELDNUT TAB 3 |
| 6 | 1 | 601-56-2958 | RIGHT BAR MOUNT |
| 7 | 1 | 601-56-2959 | LEFT BAR MOUNT |
| 8 | 1 | 601-56-3042 | RIGHT FRAME MOUNT WELDMENT |
| 9 | 1 | 601-56-3043 | LEFT FRAME MOUNT WELDMENT |
| 10 | 1 | 60A-56-0894 | 600-56-0894 ASSEMBLED |
| 11 | 1 | 60K-56-0057 | HARDWARE KIT #57 |
| 12 | 1 | 60K-56-0062 | HARDWARE KIT #62 |

REMOVE CONTENTS FROM BOX AND VERIFY ALL PARTS ARE PRESENT.
If there are any questions, call 1-855 HHTOUGH or email
HHORDERS@hammerheadarmor.com



2015-2019 Chevrolet 2500-3500 Front

II. TOOL LIST

1. ¾" wrench
2. ¾" socket
3. Flathead screwdriver
4. 10mm socket
5. 15mm socket
6. 18mm socket
7. 18mm wrench

III. REMOVAL OF OEM BUMPER

1. Using flathead screwdriver, remove 12 plastic retainers in OEM plastic shroud. Gently set aside. It will be reused.

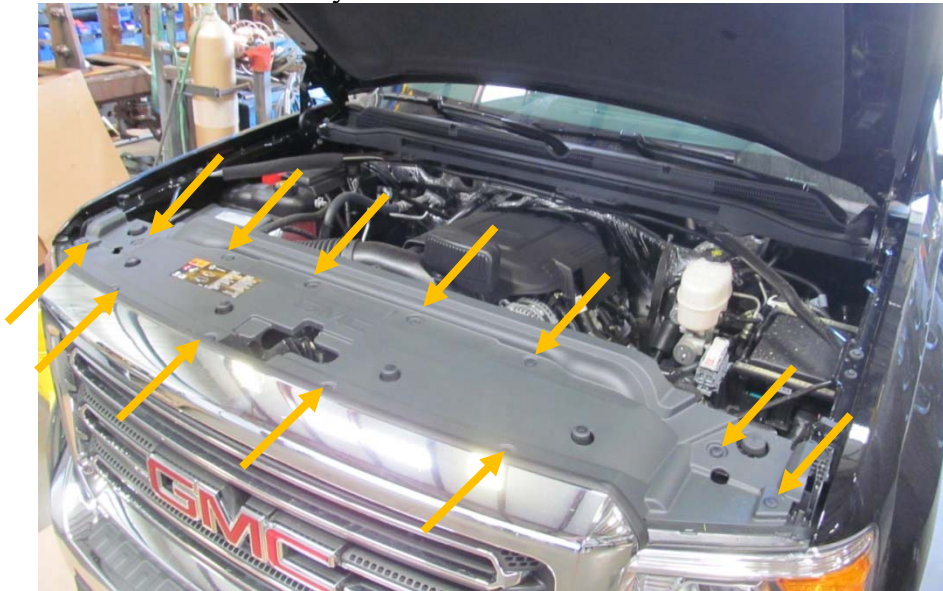

2. Using 10mm socket, remove four screws in top of grill.

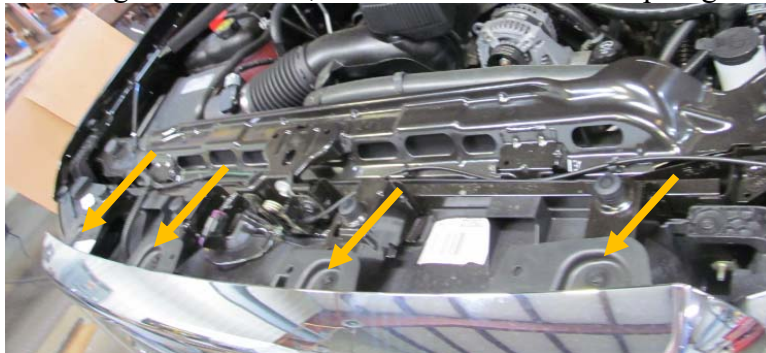



2015-2019 Chevrolet 2500-3500 Front

3. Gently pull out on grill to remove. Start at top by pulling up and then out. Then pull out on bottom. Gently set aside. It will be reused.



4. Using 15mm socket, remove 3 bolts from OEM bumper side brace. Set aside. (both sides)



5. Unplug OEM sensor/fog light harness. (if applicable)





2015-2019 Chevrolet 2500-3500 Front

6. Using 18mm socket, remove four bolts holding on OEM bumper. Set bumper aside.

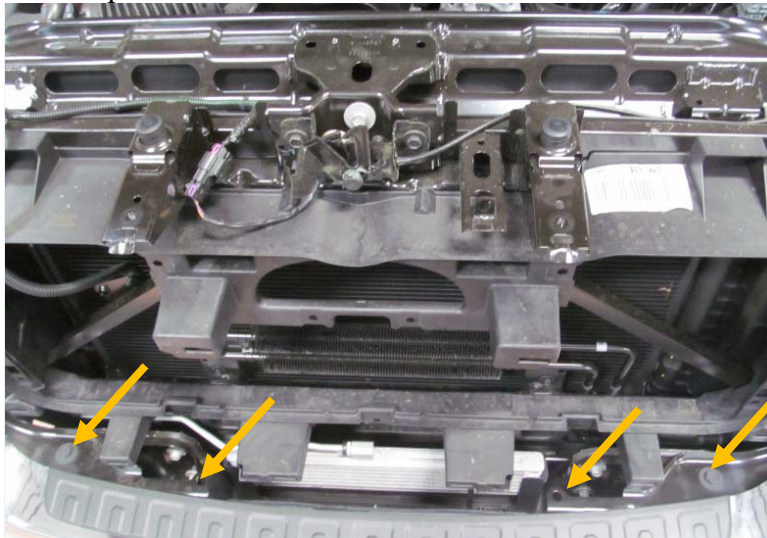

7. Using 15mm socket, remove eight bolts holding on OEM bumper brackets. Set brackets aside.

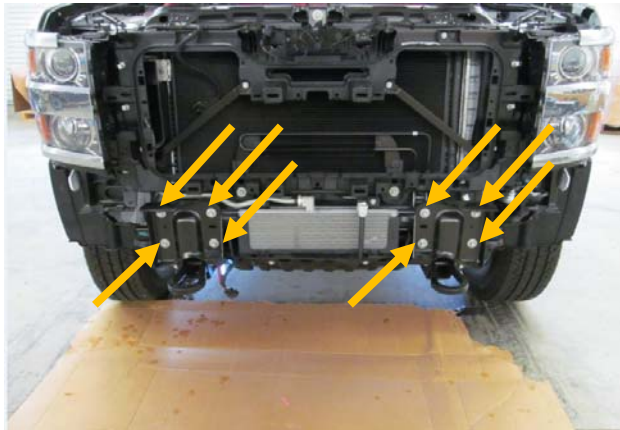

8. Using 18mm socket and wrench, remove OEM tow hook. Set tow hook aside. (both sides)





2015-2019 Chevrolet 2500-3500 Front

IV. **INSTALLATION OF HAMMERHEAD BUMPER**

1. If your truck is equipped with sensors, install OEM sensor grommets in two outer holes of Hammerhead bumper. Make sure they are oriented in the same way they were in the OEM bumper.



2. Install Hammerhead sensor solutions (601-56-2401) in two center holes of Hammerhead bumper. Then install OEM sensors and wiring harness. Make sure the sensors are oriented in the same way they were in the OEM bumper. NOTE: The plug will be horizontal.



3. If your truck is not equipped with sensors, install provided plugs in sensor holes.



4. Install all lights in Hammerhead bumper at this time. Use included Bar mount brackets (601-56-2958 and 2959) and Hardware kit #57 to attach 20" bar in bumper to mount in bumper. Use hole in bracket and bumper that works best with your light bar. Tighten bolts from hardware kit #57 with 7/16" socket and wrench.



2958 and 2959 brackets

5. Reinstall OEM grill and plastic shroud using OEM hardware.



2015-2019 Chevrolet 2500-3500 Front

6. Lay out frame mounts as shown.



7. Using OEM hardware, install Hammerhead Frame mounts on frame as shown. Do not fully tighten.

8. Using Hardware from Kit#62 install bolts, flat washers, lock washers, and weldnut tab (601-56-2498) in bottom of frame mount through bottom OEM tow hook bolt hole. (A) Weldnut tab can be inserted through front of Hammerhead frame mount. (B) Do not fully tighten.

You will need:

| Qty | Description |
|-----|----------------------------|
| 2 | 1/2"-13 x 2" hex head bolt |
| 2 | 1/2" flat washer |
| 2 | 1/2" lock washer |
| 2 | Weldnut tab (601-56-2498) |





2015-2019 Chevrolet 2500-3500 Front

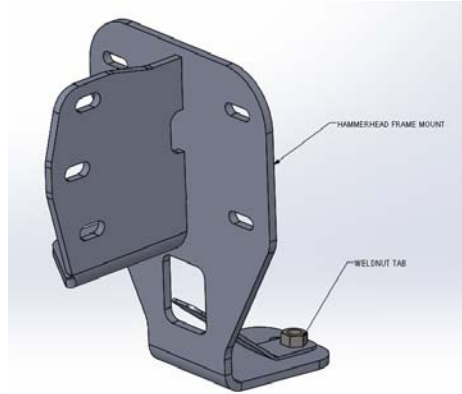

9. Using hardware from kit #62 and weldnut tab 3(qty-2), install Hammerhead bumper on frame mounts. Run bolts toward the center of the vehicle and use weldnut tab 3 on inside. This will make the bolts easier to reach with wrench or socket when tightening.

You will need:

| Qty | Description |
|-----|-----------------------------|
| 6 | 1/2"-13 x 2" hex head bolt |
| 12 | 1/2" flat washer |
| 6 | 1/2" lock washer |
| 6 | 1/2"-13 hex head nut |
| 2 | Weldnut tab 3 (601-56-2868) |

10. Align bumper a minimum of 1/4" below headlights. When truck flexes off-road, this distance allows your bumper and body to have clearance. Fully tighten all hardware.



Congratulations! Your bumper installation is now complete.
Thank you for your purchase.