

HEAVY DUTY BUMPER INSTALLATION

2016-2018 - Chevrolet 1500

AL-FBM16CHN-RT

7/15/20

Hardware Kit Includes:

- (1) 4 – Hex head nuts (M12-1.5) Grade 8
- (2) 4 – Lock washers (M12) Grade 8
- (3) 4 – Flat washers (M12) Grade 8
- (4) 4 – Push-nuts (M12)
- (5) 2 – M10-1.5 x 25mm Hex Head Bolts
- (6) 4 – M10 Flat Washers
- (7) 2 – M10 Lock Washers
- (8) 2 – M10-1.5 Hex Head Nuts
- (9) 4 – M8-1.25 x 25mm Hex Head Bolts
- (10) 4 – M8 Flat Washers
- (11) 4 – M8 Flanged Hex Head Nuts
- (12) 6 – M8-1.25 x 25mm Button Head Bolt
- (13) 12 – M8 Flat Washer
- (14) 6 – M8 Nylock Nuts

Components List:

- 1 – AL-FBM16CHN-RT Aluminum Bumper
- 1 – RT Light Mount
- 2 – RT Light Mount Foam Gaskets
- 4 – RT Light Mount Plugs
- 2 – 10mm License Plate Plugs
- 4 – Sensor Plugs
- 2 – Mounting brackets (BP5814)
- 1 – Skid Plate
- 2 – T-Bolts (BP2032)
- 2 – Mounting Bracket/Bumper Insulator (100297)

DISCLAIMER: USE ONLY COMPONENTS AND HARDWARE SUPPLIED. NO SUBSTITUTIONS.

LOOSE FIT ALL COMPONENTS. DO NOT TIGHTEN UNTIL ALL COMPONENTS ARE INSTALLED AND ADJUSTED.

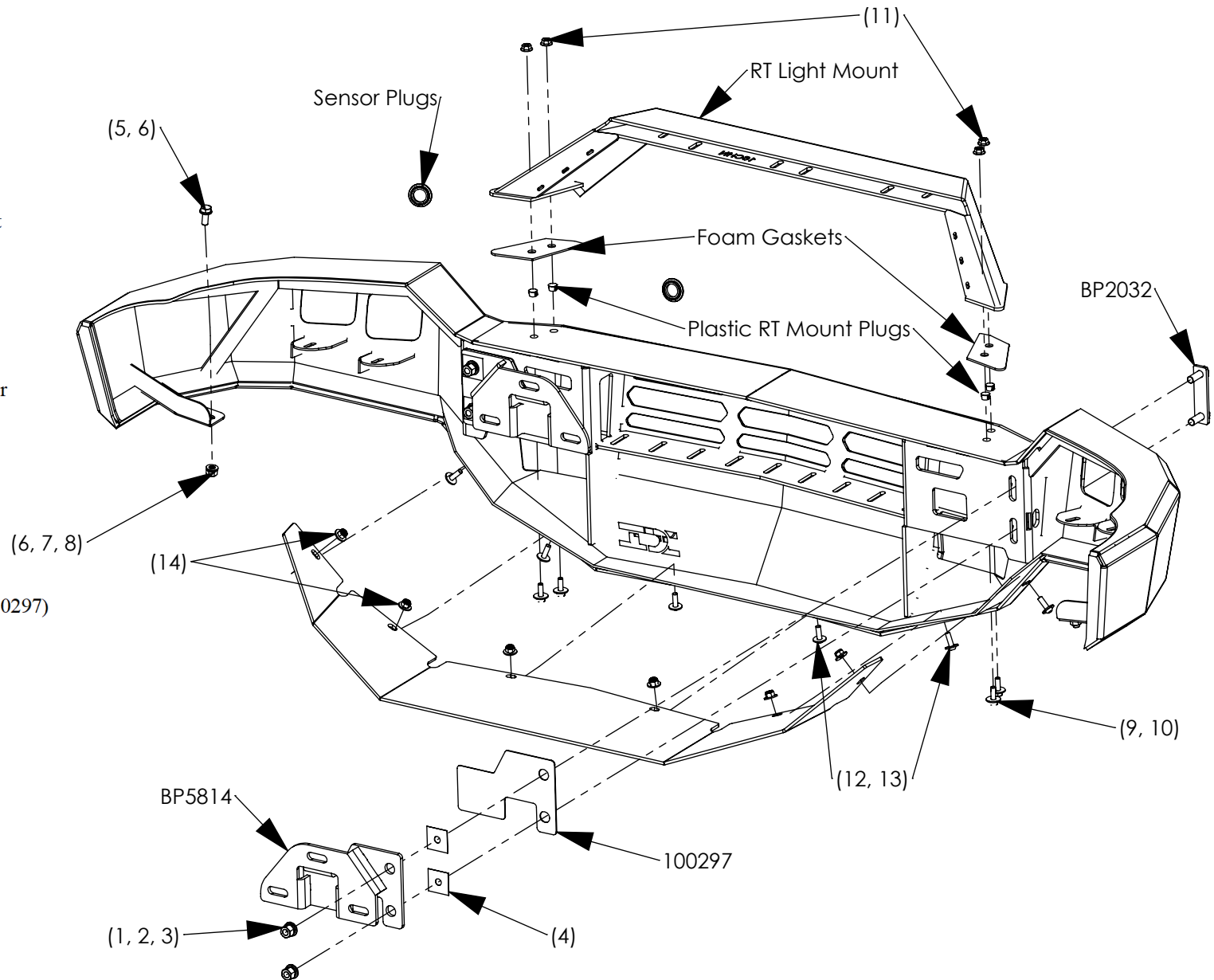

1. Start by opening the hood of the vehicle and disconnecting the negative battery terminal.
2. Remove the black radiator/grille cover panel located just behind the front grille and above the radiator core support. Remove the 12 plastic push pins and remove the panel.
3. Next you will need to unbolt the factory grille assembly. Remove the four top 10mm retaining bolts. Starting at one lower corner, carefully pull outward on the fascia until the clips begin to release. Carefully work your way around the vehicle from one side to the other. Take care not to damage the fascia or the plastic tabs as you will be re-installing these pieces. Set the grille assembly aside on a soft blanket to protect against scratches.
4. The next step is to remove the remaining factory bumper assembly. Disconnect the fog lamp and sensor wiring harness (if so equipped) and wire loom retaining clips from the bumper support brackets and tie them up safely out of the way. Remove the two outer bumper to frame support braces just behind the fog lamps and set aside for reuse. There are 4 bolts holding bumper to the frame, they can all be accessed from the top center of the bumper. Using either a floor jack or the help of friends, support the bumper while you remove the 4 bumper bolts attaching it to the frame. Gently remove the bumper from the vehicle.
5. Once the bumper has been removed from the truck, remove the two bumper frame brackets by removing the 6 bolts (3 per side) holding the brackets to the front frame of the truck. Save the bolts to be reused with the Alumilite bumper.
6. Locate the BP5814 mounting brackets supplied with your new Alumilite Bumper. Install the brackets onto the frame re-using the six factory hardware bolts (3 per side) removed in Step 5. Do not fully tighten the brackets to the frame, make sure they can slide in the slot for adjustment.

**DISCLAIMER: USE ONLY COMPONENTS
AND HARDWARE SUPPLIED.
NO SUBSTITUTIONS.**

**LOOSE FIT ALL COMPONENTS.
DO NOT TIGHTEN UNTIL ALL
COMPONENTS ARE INSTALLED
AND ADJUSTED.**

7. Install the skid plate onto the bottom of the bumper using the six provided button head bolts. The skid plate should sit on the back side of the bumper. Tighten the M8 hardware holding the skid plate to the bumper.
8. The RT Light mount is bolted on the top of the bumper using M8 hardware. The foam gasket should be placed between the bumper and RT Mount to prevent squeaking. If the RT Light Mount is not used, plug the four holes in the top of the bumper with the RT Mount Plugs.
9. Next, install the two supplied BP2032 T-Bolts in the slots in the inside bumper brackets. The bolts go in from behind the bracket and face outward. Use the supplied M12 push nuts from the hardware kit to hold T-Bolts in place. Install the plastic insulator (100297) on the face of the bracket so it will go between the bumper and outside mounting brackets, this will isolate any contact between the aluminum and steel parts. Also, remove the sensors, sensor bezels and wiring harness from the factory bumper, note where each sensor was located and the orientation of the wiring harness.
10. With help or using a floor jack, lift the bumper up and onto the frame brackets already installed on the frame. Attach using the remaining M12 hex nuts, flat and lock washers. Align the bumper to the vehicle and tighten all M12 hardware and factory bolts holding the brackets to the frame. It may be necessary to shim the bumper with washers between the bracket and bumper (washers are not provided).
11. After the frame brackets are tight, re-attach the factory side supports to the frame and Alumilite bumper. For the supports to line up properly, you must attach the driver side support to the passenger side mounting points and the passenger side support to the driver side mounting points. Re-use the factory hardware to attach the supports to the frame and the provided hardware to attach the supports to the Alumilite bumper. It may be necessary to shim the supports with washers (washers are not provided).
12. After your new Alumilite bumper has been installed and properly aligned, install the sensors into the Alumilite bumper and route the sensor wiring harness through the inside brackets of the bumpers. Zip tie any loose areas and plug the harness back into the truck. If the truck is not equipped with sensors, use the sensor plugs to plug the holes in the bumper. Also, install any lighting and wire according to light manufacturers specs.
13. Reinstall the grille and radiator grille cover in reverse of removal process. Reconnect negative battery terminal. Enjoy your Alumilite bumper!