

Heavy Duty Front Bumper 2005-2015 Toyota Tacoma **AL-FBM90TYN-RT**

7/16/20

2005-2015 Toyota Tacoma with Winch Carrier

Bumper Hardware Kit Includes:

- (1) 2 – Hex head bolts (M12-1.75 x 40mm) Grade 8
- (2) 10 – Flat washers (M12- O.D 24x2.5mm) Grade 8
- (3) 2 – Flat washers (M12 – O.D 37x3mm) Grade 8
- (4) 10 – Lock washers (M12) Grade 8
- (5) 8 – Hex head nuts (M12-1.5mm) Grade 8
- (6) 4 – Plastic Push Nuts (M12)
- (7) 4 – Hex head bolts (M8-1.25 x 25mm) Grade 8
- (8) 4 – Flanged hex head nuts (M8-1.25) Grade 8
- (9) 4 – Flat washers (M8 – O.D. 24mmx2.5mm)

Components List:

- 1 – Heavy Duty Bumper
- 2 – RT Assembly
- 3 – Winch Carrier BP5294
- 4 – (4) T-Bolts BP2032
- 5 – (2) Nut Plates BP5287
- 6 – (2) Mounting brackets BP5298 (1 Driv/1 Pass)
- 7 – (2) Washer Plates BP5302
- 8 – (2) Inside/Outside Bracket Insulator 100441
- 9 – (2) Adhesive Foam Strips for RT

**LOOSE FIT ALL COMPONENTS.
DO NOT TIGHTEN UNTIL ALL
COMPONENTS ARE INSTALLED
AND ADJUSTED.**

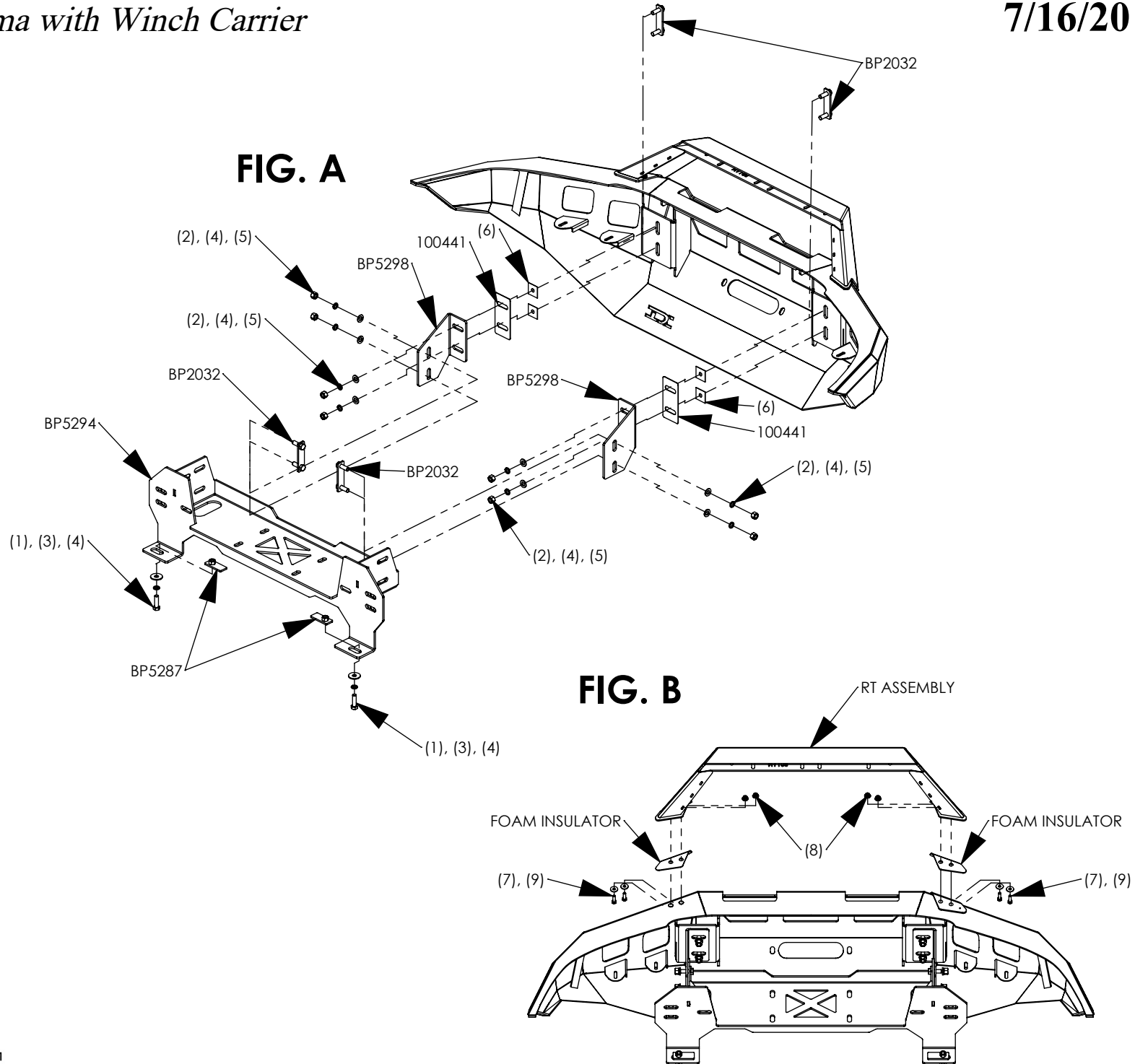

ATTN: STATE OF CALIFORNIA CONSUMERS
WARNING: CANCER AND REPRODUCTIVE HARM
-WWW.P65WARNINGS.CA.GOV

Visit the ICI Website for other exciting accessories for your vehicle. www.icionline.com

Heavy Duty Front Bumper 2005-2015 Toyota Tacoma AL-FBM90TYN-RT

2005-2015 Toyota Tacoma with Winch Carrier

7/16/20

Step-by-Step

1. Disconnect negative battery terminal.
2. Open hood and remove two screws and two plastic clips in top of grille shell. In the lower inside corners there are two more clips that get released to remove the grille shell.
3. Disconnect fog lights if equipped.
4. There are 4 screws and 7 clips holding the plastic bumper to the truck. The screws are in the wheel well area and the plastic clips run across the top and bottom of the bumper. Once removed, carefully remove bumper by gently pulling outward until the bumper releases.
5. Remove the front bumper reinforcement subassembly by unbolting the 6 nuts (3 per side) that hold the reinforcement to the frame.
6. Unbolt the tie down hook from the passenger side front bumper cross member and unbolt the cross member extensions from both sides of the front bumper cross member and remove them. None of these parts will be re-used with the Alumilite bumper.
7. Reinstall the factory grille shell.
8. Install the winch carrier by lining it up with the factory studs coming out the front of the frame. Using provided washer plates BP5302 for the outside studs and a flat washer for the inside studs, loosely install the factory nuts. Next, insert the provided nut plates BP5287 inside the front bumper cross member so they line up with the holes in the bottom of the cross member and install provided M12 bolts, flat and lock washers through the winch carrier and into the nut plate. Once fitted, fully tighten winch carrier.
9. Install the mounting brackets to the bumper using the provided BP2032 T-Bolts and hardware. Do not fully tighten brackets to the bumper (FIG. A).
10. With help, lift up the Alumilite bumper with mounting brackets attached and align with slots in the side of the winch carrier. Insert provided T-Bolts from the inside of the winch carrier through the mounting brackets and attach hardware. Do not fully tighten.
11. Once the bumper is loose fit to the winch carrier, adjust the bumper up/down and side/side until satisfied and tighten mounting brackets to bumper and to winch carrier.